

1. Port size		50 X 336 [mm]
2. Leak rate		
- Body	` External Leak rate	$< 1 \times 10^{-9} / \text{Pa} \cdot \text{M}^3 / \text{s He.}$
- Gate Disk	` Internal Leak rate	$< 5 \times 10^{-9} / \text{Pa} \cdot \text{M}^3 / \text{s He.}$
3. Clamping type	` [With Align pins]	Single wall(Claw) Clamp
4. Differential pressure at opening		Negative[F.V.~Atm Across disc]
5. Temperature		
- Body		$< 5 \sim 150^{\circ}\text{C}$
- Actuator		$< 5 \sim 80^{\circ}\text{C}$
6. Operation		Double Acting Cylinder
7. CDA Supply		0.5MPa~0.7MPa
8. Material		
- Body Ass'y	` Hairline seal surface treat with micro fine	AL6061 Bare
- Gate disc		AL6061 Bare
- STEM Seal (Bellows)		AM350/SUS 316L (Flange: SUS304)
- Bonnet Seal		FKM Elastomer
- DISC Seal		FKM Elastomer
9. Open & Shut time		$< 2.5 \text{ Sec [Switch to switch]}$
10. Stroke		110mm
11. Safty CDA Fitting		Rc 1/8 " Speed control
12. Product Weight		15 Kg
13. Open & Close type		"L-Motion Drive And Roller Cam closing Method

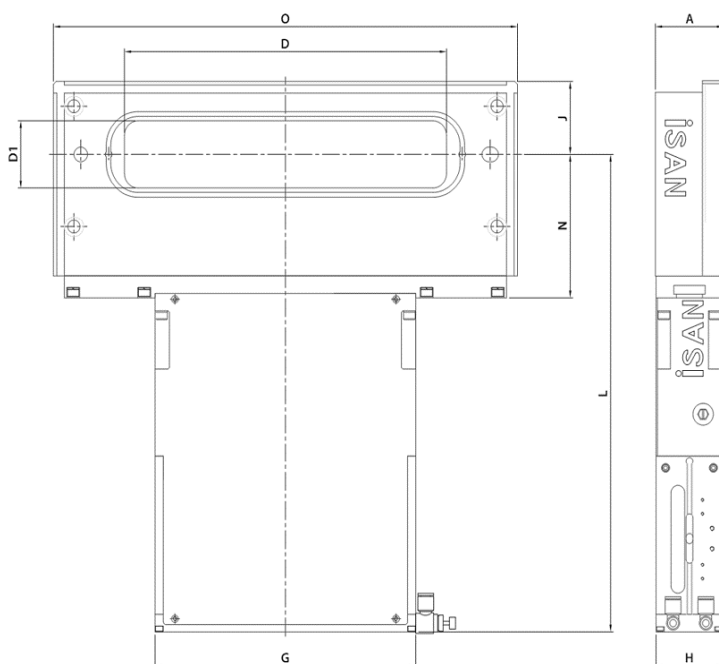

Dimension

A	60
	2.36
D	336
	13.23
D1	50
	1.97
G	224
	8.82
H	59
	2.32
J	52
	2.05
L	375
	14.76
N	106
	4.17
O	440
	17.32